

Rubber Fab

a Garlock Hygienic Technologies company

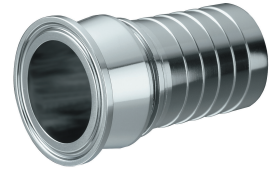

Tri-Clamp® x Hose Barb

Hose ID Inch	Part Number	Description	Fitting ID Inch	Flange Diameter Inch	Fitting Overall Length
1/4	04HB-08TC-SS	.25in Hose Barb x .5in Mini Tri-Clamp® 316SS	0.19	0.99	1.31
1/4	04HB-12TC-SS	.25in Hose Barb x .75in Mini Tri-Clamp® 316SS	0.19	0.99	1.31
1/4	04HB-16TC-SS	.25in Hose Barb x 1in Tri-Clamp® 316SS	0.19	1.98	1.46
3/8	06HB-08TC-SS	.375in Hose Barb x .5in Mini Tri-Clamp® 316SS	0.28	0.98	1.50
3/8	06HB-12TC-SS	.375in Hose Barb x .75in Mini Tri-Clamp® 316SS	0.28	0.99	1.50
3/8	06HB-16TC-SS	.375in Hose Barb x 1in Tri-Clamp® 316SS	0.28	1.98	1.84
1/2	08HB-08TC-SS	.5in Hose Barb x .5in Mini Tri-Clamp® 316SS	0.37	0.98	1.81
1/2	08HB-12TC-SS	.5in Hose Barb x .75in Mini Tri-Clamp® 316SS	0.37	0.98	1.81
1/2	08HB-16TC-SS	.5in Hose Barb x 1in Tri-Clamp® 316SS	0.37	1.98	2.00
5/8	10HB-12TC-SS	.625in Hose Barb x .75in Mini Tri-Clamp® 316SS	0.48	0.98	1.78
3/4	12HB-12TC-SS	.75in Hose Barb x .75in Mini Tri-Clamp® 316SS	0.62	0.98	2.10
3/4	12HB-16TC-SS	.75in Hose Barb x 1in Tri-Clamp® 316SS	0.62	1.98	2.09
1	16HB-16TC-SS	1in Hose Barb x 1in Tri-Clamp® 316SS	0.87	1.98	2.29
1	16HB-24TC-SS	1in Hose Barb x 1.5in Tri-Clamp® 316SS	0.87	1.98	2.29
1-1/2	24HBL-24TC-SS	1.5in Long Hose Barb x 1.5in Tri-Clamp® 316SS	1.36	1.98	3.13
1-1/2	24HBL-32TC-SS	1.5in Long Hose Barb x 2in Tri-Clamp® 316SS	1.37	2.52	8.13
1-1/2	24HBS-24TC-SS	1.5in Short Hose Barb x 1.5in Tri-Clamp® 316SS	1.38	1.98	2.33
1-1/2	24HBS-32TC-SS	1.5in Short Hose Barb x 2in Tri-Clamp® 316SS	1.37	2.52	2.00
2	32HBL-32TC-SS	2in Long Hose Barb x 2in Tri-Clamp® 316SS	1.84	2.52	3.80
2	32HBS-32TC-SS	2in Short Hose Barb x 2in Tri-Clamp® 316SS	1.84	2.52	2.39
2-1/2	40HBL-40TC-SS	2.5in Long Hose Barb x 2.5in Tri-Clamp® 316SS	2.23	3.05	4.19
3	48HBL-48TC-SS	3in Long Hose Barb x 3in Tri-Clamp® 316SS	2.75	3.58	4.34
3	48HBS-48TC-SS	3in Short Hose Barb x 3in Tri-Clamp® 316SS	2.75	3.58	3.39
4	64HBL-64TC-SS	4in Long Hose Barb x 4in Tri-Clamp® 316SS	3.75	4.68	5.00
4	64HBS-64TC-SS	4in Short Hose Barb x 4in Tri-Clamp® 316SS	3.81	4.68	4.18
6	96HBL-96TC-SS	6in Long Hose Barb x 6in Tri-Clamp® 316SS	5.75	6.57	6.00
6	96HBS-96TC-SS	6in Silicone Hose Barb x 6in Tri-Clamp® 316SS	5.75	6.57	5.00

Also available:

304 Stainless Steel

DIN style fittings

Step up and step down fittings in all sizes.

Consult factory for more information.

Note:

Tri-Clamps® larger than 1in have hose barbs that are specially designed for a hose type.

HBL = Long Barb

Long Barbs are used for PTFE lined and FDA Rubber hoses.

HBS = Short Barb

Short Barbs are used for Silicone and PVC hoses.



26 Brookfield Drive • Sparta, New Jersey 07871

973.579.2959 • 866-442-2959 Toll Free • 973.579.7275 Fax • www.rubberfab.com